

# HIGHLIGHT SPWSPL Specifications



## Why us?

### **Innovative Technology**

High-efficiency solar and advanced LEDs deliver superior performance, long life, and maximum ROI.

### **Photometric**

We conduct photometric measurements on all our products to ensure optimal performance and compliance with industry standards

### **Versatile Lighting**

We design and install solar-powered lighting systems tailored for all kinds of locations such as streets, parks, pathways, homes, etc.

### **Global Reach**

Worldwide success proves our adaptability and regulatory expertise.

### **Sustainable Savings**

These solutions enhance safety, promote sustainability and provide significant energy and cost savings.

### **Warranty**

SolarPath is dedicated to delivering architectural and commercial-grade solar lighting that can be customized to meet specific client requests, both in technical specifications and aesthetic design, ensuring a perfect fit for a diverse range of needs.



The SolarPath HIGHLIGHT SPWSPL™ is the premier LED solar illumination technology in its class today. Ultra-bright/High Intensity LED lighting means a total lighting solution for any need. The solar panel is wrapped and can be installed on a new or an existing pole. It is new technology. This product has both a solar engine and a LED light. The battery and controller are on the LED head which allow this product to be used for, roads, parking lot, pathway, etc. The lighting fixture can be used up to 100W and can be controlled via remote control.

## Technical specification

|                                |   |   |
|--------------------------------|---|---|
| <b>Solar Module Parameters</b> | Type  | High-efficiency Monocrystalline Silicon |
|                                | Power   | Up to **560W / 1200W                    |
| <b>Solar Charge Controller</b> | MPPT (Maximum Power Point Tracking), infrared solar charging controller |   |
| <b>Battery</b>                 | LifePO  | Up to 90AH                              |
| <b>LED Light Parameters</b>    | Light Source Power  | Up to 100W                              |
|                                |   | LED A – 1W/140Lm                        |
|                                |   | LED B – 1W/130Lm                        |
|                                | CCT (Correlated color temperature)                                      | 3,000K-6,000K/ Amber                    |
|                                | CRI (Color rendering index)   | <u>≥81</u>                              |
| <b>Control Modes</b>           | Manual ON/OFF / Automatically ON/OFF / Time Control                     |   |
| <b>Operation mode</b>          | Depend on installation area, can be programed with remote control       |   |
| <b>IP Rating</b>               | IP67  |   |
| <b>Product Size</b>            | Light Body  | Depend On LED power                     |
|                                | Solar Panel   | Depend On Solar Panel wattage           |
| <b>Net Weight</b>              | Light Body  | Depend On LED power                     |
|                                | Solar Panel   | Depend On Solar Panel wattage           |

## Vertical Solar Module



### Main Specification

|                    |  |                       |
|--------------------|--|-----------------------|
| Model              | VSP-140                                | VSP-200               |
| Specification      | 140W 18V/36V MONO                      | 200W 18V/36V MONO     |
| Dimension          | 8.97''*7.87''*61.41''                  | 8.97''*7.87''*81.10'' |
| Pole diameter      | 2.95''~5.51''                          | ●                     |
| Cell efficiency    | 22.5%                                  | ●                     |
| Structure material | UPVC + aluminum alloy / aluminum alloy |                       |
| Lifetime           | >20 years lifetime                     |                       |
| Warranty           | 5 years                                |                       |



## GeoFlex/ Polygonal Photovoltaic Module

The GeoFlex Series features a foldable polygonal solar panel design, adaptable to shapes like hexagons or octagons for customizable power output. Its foldable structure reduces packaging volume by over 50%, lowering international shipping costs. With a modular design, it easily expands for higher power needs, while 360-degree charging ensures maximum sunlight capture.

The vertical cylindrical panels provide superior wind resistance and a sleek, urban-friendly design that prevents snow accumulation and enhances durability. Ideal for solar streetlights, surveillance systems, and traffic signals, the GeoFlex Series combines functionality, efficiency, and seamless urban integration.



Hexagon

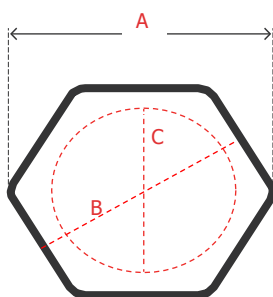

**OCTAGON**

8 Sides  
A = 10.62" B = 11.41" C = 7.48"

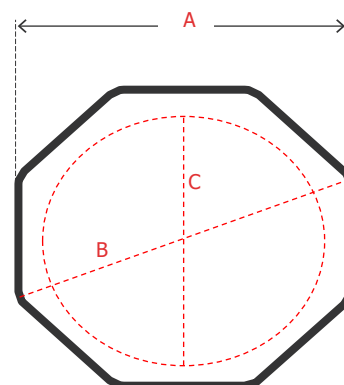

**HEXAGON**

6 Sides  
A = 8.85" B = 7.71" C = 4.72"



Octagon

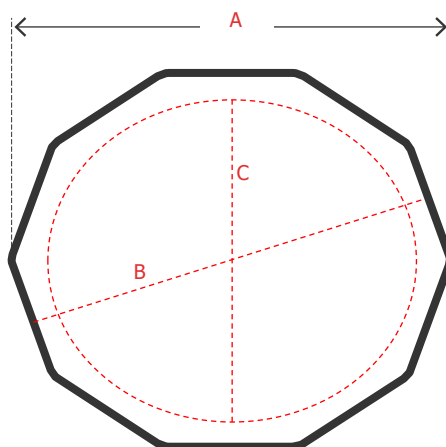

**DECAGON**

10 Sides  
A = 14.17" B = 13.38" C = 10.23"

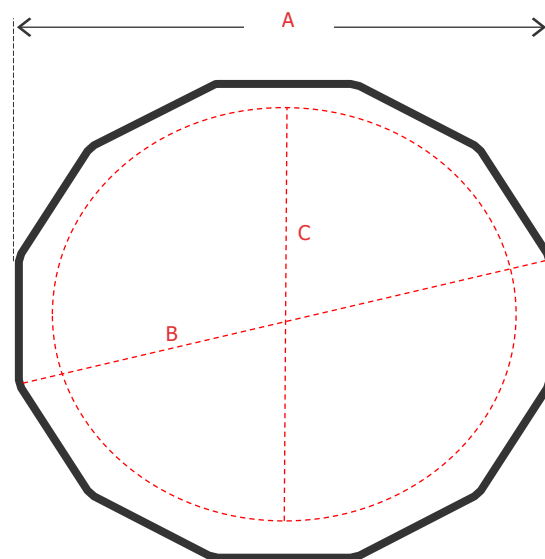

**DODECAGON**

12 Sides  
A = 16.14" B = 16.73" C = 12.99"



Decagon

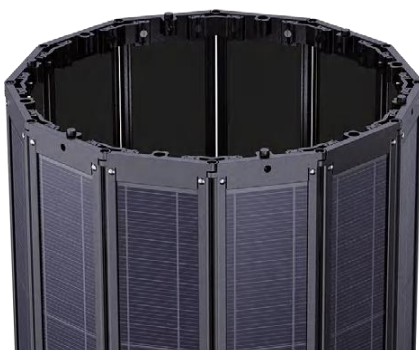

Dodecagon

## Vertical Solar Tube

**80W I 100W I 140W**

Designed in U.S.A and assembled in P.R.C, SolarWrap vertical solar cylinder represents an innovative solution tailored for pole-mounted Applications. Distinguished from conventional solar panels, poles equipped with the SolarWrap cylinder exhibit exceptional aesthetic appeal, seamlessly integrating into serene environments while retaining the appearance of traditional poles, albeit enhanced with beauty. Its versatility extends to various Applications including solar light poles, solar camera poles, and solar traffic signs.



### Main Specification

| Model              | VST-80                                   | VST-100       | VST-140       |
|--------------------|--|---------------|---------------|
| Specification      | 80W 6V MONO                              | 100W 6V MONO  | 140W 9V MONO  |
| Dimension          | D6.29"*40.94"                            | D6.29"*40.94" | D9.44"*40.94" |
| Pole diameter      | 2.36"~3.54"                              | 2.75"~4.72"   | 3.14"~6.69"   |
| Cell efficiency    | 22.5%                                    | ●             | ●             |
| Structure material | Tempered glass + aluminium alloy profile |               | ●             |
| Lifetime           | >20 years lifetime                       | ●             | ●             |
| Warranty           | 5 years                                  | ●             | ●             |



## Lithium Battery Cylinder

### Built into Poles I Outside of Poles

Introducing the S&R Series Lithium Battery Pack – the ultimate power solution tailored for outdoor lighting and versatile Applications. Designed to fit seamlessly within lamp poles, the S & R Series redefines efficiency and durability, making it the perfect choice for solar streetlights, solar-powered surveillance systems, and solar advertising displays.

Crafted with a robust aluminum alloy casing and an IP67 waterproof rating, this battery pack is built to withstand the toughest environmental challenges. Its customizable capacity ensures it adapts to your unique energy needs, delivering unmatched performance.

Whether powering outdoor systems or providing rapid indoor electricity supply, the S & R Series guarantees reliability and flexibility. Elevate your projects with this state-of-the-art energy solution, engineered for excellence in every detail.



## Lithium Battery Cylinder

### S Series

#### LiFePO4 Lithium Battery Cylinder



| Battery Spec           | S1236              | S1260              | S1290              | S2560              |
|------------------------|--------------------|--------------------|--------------------|--------------------|
| Battery Cell           | 6000mA 3.2V 32700  | ●                  | ●                  | ●                  |
| Nominal Capacity       | 12.8V 36AH         | 12.8V 60AH         | 12.8V 90AH         | 25.6V 60AH         |
| Battery Cell Quantity  | 24 pieces          | 40 pieces          | 52 pieces          | 80 pieces          |
| Array Mode             | 6P4S               | 10P4S              | 13P4S              | 10P8S              |
| Dimension (L*W*H)      | 12.59"*4.92"*4.25" | 20.07"*4.92"*4.25" | 27.95"*4.92"*4.25" | 36.22"*4.92"*4.25" |
| Net Weight             | 9.03lbs            | 11.68lbs           | 18.07lbs           | 27.55lbs           |
| Charge Mode            | C.C +C.V           | ●                  | ●                  | ●                  |
| Charge Cut-off Vol     | 14.6±0.05V         | ●                  | ●                  | ●                  |
| Discharge Cut-off Volt | 11±0.05V           | ●                  | ●                  | ●                  |
| Storage Temperature    | 41F~95F            | ●                  | ●                  | ●                  |
| Operating Temperature  | 5F~+113F           | ●                  | ●                  | ●                  |
| Lifetime (D.OD. 60%)   | 4,000 cycles       | ●                  | ●                  | ●                  |
| Warranty               | 3 Years            | ●                  | ●                  | ●                  |

### R Series

#### LiFePO4 Lithium Battery Cylinder



| Battery Spec              | R1260              | R1290          | R2460          | R2490          |
|---------------------------|--------------------|----------------|----------------|----------------|
| Battery Cell              | 15000mA 3.2V 32140 | ●              | ●              | ●              |
| Nominal Capacity          | 12.8V 60AH         | 12.8V 90AH     | 25.6V 60AH     | 25.6V 90AH     |
| Battery Cell Quantity     | 16 pieces          | 24 pieces      | 32 pieces      | 40 pieces      |
| Array Mode                | 4P4S               | 6P4S           | 4P8S           | 5P8S           |
| Dimension (L*Dia)         | L13.38"*D5.90"     | L24.40"*D5.90" | L24.40"*D5.95" | L47.24"*D5.95" |
| Net Weight                | 12.12lbs           | 17.19lbs       | 22.70lbs       | 34.17lbs       |
| Charge Mode               | C.C +C.V           |                |                |                |
| Charge Cut-off Voltage    | 29.2±0.05V         |                |                |                |
| Discharge Cut-off Voltage | 22±0.05V           |                |                |                |
| Storage Temperature       | 5F~95F             |                |                |                |
| Operating Temperature     | 5F~+113F           |                |                |                |
| Lifetime (D.OD. 60%)      | 4,000 cycles       |                |                |                |
| Warranty                  | 3 Years            |                |                |                |

## Key Features

- Can be installed on existing pole.
- Low installation and maintenance costs.
- Folding solar panel.
- IP 67 Rating.
- Solar powered outdoor lighting.
- Battery, solar controller are built inside of light.
- Good appearance, small size and lightweight, easy to install.
- Rust-proof, dustproof and waterproof.
- Energy saving 100% generated from solar less power consumption than traditional.

## Solar Street Light

---

### USES AND APPLICATIONS GUIDE

Streets Lighting

Parking Lots



Residential Roads

Public Parks

Sports Lighting

## ORDERING GUIDE

Ordering Guide: EXAMPLE: HIGHLIGHT SPWSPL-A-\*\*RD-18V-\*\*80W-A-15W-3-30K-36AH-1-GR-00

| Model            | Solar Panel Qty. | Solar Panel Type | Voltage | Solar Panel | LED Head  | LED Power |      | Distribution Type | LED Color Temp | Battery Options | Arm        | LED Body Color | Motion Sensor          |
|------------------|------------------|------------------|---------|-------------|---|-----------|------|-------------------|----------------|-----------------|------------|----------------|------------------------|
| HIGHLIGHT SPWSPL | A- 1 pc          | **RD-Round       | 18V     | **80W       | A -  | 15W       | 20W  | B - Type III      | 30K            | 36AH            | 1 - Single | GR - Grey      | 00 - No motion sensor  |
|                  | B- 2 pcs         | HE- Hexagon      | 36V     | **100W      |   | 20W       | 30W  |                   | 40K            | 60AH            |            |                |                        |
|                  | C- 3 pcs         | OC- Octagon      |         | **140W      | B -  | 30W       | 40W  |                   | 60K            | 90AH            | 2 - Dual   |                | 01 - Motion sensor     |
|                  | D- 4 pcs         | DE- Decagon      |         | 150W        |   | 40W       | 50W  |                   | *Amber         |                 |            |                |                        |
|                  |                  |                  |         | 200W        |   | 50W       | 60W  |                   | (*MOQ- 200pcs) |                 |            |                |                        |
|                  |                  | DO- Dodecagon    |         | 250W        |   | 60W       | 80W  |                   |                |                 |            |                |                        |
|                  |                  |                  |         | 300W        |   |           | 100W |                   |                |                 |            |                | *Available type A only |



\*Up on request

Legal Clarification: All technical information and/or products listings and/or technical support, and/or any kind of graphics, illustrations and/or instructions and/or the names, trade names, trademarks, trade symbols, service marks, logos, icons and trade dress of SolarPath Inc or in connection to SolarPath Inc or any of its selling products, contained herein is in the exclusive ownership of SolarPath Inc and may not be alternated and/or used in any manner including but not limited to copy of some or all of the said material by users and/or viewers or any third party for that matter of this document and the website to which it is linked without the express prior written permission of SolarPath Inc. Furthermore, redistribution or any kind of commercial use or alternation or any kind of use other than downloading presented information in some or all contents of downloadable documents, and/or downloadable contents, is strictly prohibited without express written prior permission. All information set out herein is subject to changes as may occur from time to time. SolarPath Inc is not responsible for, and cannot guarantee and shall not be held liable for any information or the accuracy of such in websites that it does not manage



## Contact us



+1.201.490.4499

Toll free: 1.888.333.SOLAR (7652)



[contact@solarpathusa.com](mailto:contact@solarpathusa.com)



[www.solarpathusa.com](http://www.solarpathusa.com)