

HIGHLIGHT SP-SODL Specifications



Why us?

Innovative Technology

High-efficiency solar and advanced LEDs deliver superior performance, long life, and maximum ROI.

Photometric

We conduct photometric measurements on all our products to ensure optimal performance and compliance with industry standards

Versatile Lighting

We design and install solar-powered lighting systems tailored for all kinds of locations such as streets, parks, pathways, homes, etc.

Global Reach

Worldwide success proves our adaptability and regulatory expertise.

Sustainable Savings

These solutions enhance safety, promote sustainability and provide significant energy and cost saving.

Warranty

SolarPath is dedicated to delivering architectural and commercial-grade solar lighting that can be customized to meet specific client requests, both in technical specifications and aesthetic design, ensuring a perfect fit for a diverse range of needs.



The SolarPath HIGHLIGHT SP-SODL™ is the premier LED solar illumination technology in its class today. Ultra-bright/High Intensity LED lighting means a total lighting solution for any need. The solar panel is wrapped and can be installed on a new or an existing pole. It is new technology. This product has both a solar engine and a LED light. The battery and controller are inside pole which allow this product to be used for, roads, parking lot, pathway, etc. The lighting fixture can be used up to 60W and can be controlled via remote control.

Technical specification

Solar Module Parameters	Type	High-efficiency Monocrystalline Silicon
	Power	Up to **560W / 1200W
Solar Charge Controller	MPPT (Maximum Power Point Tracking), infrared solar charging controller	
Battery	LifePO	Up to 90AH
LED Light Parameters	Light Source Power	Up to 60W (Up to 7,680 lm)
	CCT (Correlated color temperature)	3,000K-6,000K/ Amber
	CRI (Color rendering index)	<u>≥81</u>
Control Modes	Manual ON/OFF / Automatically ON/OFF / Time Control	
CCT	Depend on installation area, can be programed with remote control	
IP Rating	IP67	
Product Size	Light Body	Depend On LED power
	Solar Panel	Depend On Solar Panel wattage
Net Weight	Light Body	Depend On LED power
	Solar Panel	Depend On Solar Panel wattage

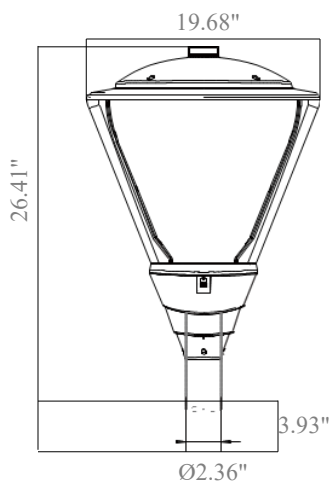

LED A

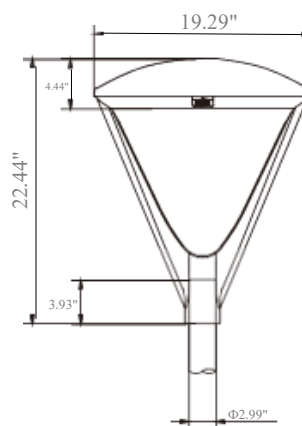

LED B

Vertical Solar Module



Main Specification

Model	VSP-140	VSP-200
Specification	140W 18V/36V MONO	200W 18V/36V MONO
Dimension	8.97''*7.87''*61.41''	8.97''*7.87''*81.10''
Pole diameter	2.95''~5.51''	●
Cell efficiency	22.5%	●
Structure material	UPVC + aluminum alloy / aluminum alloy	
Lifetime	>20 years lifetime	
Warranty	5 years	



GeoFlex/ Polygonal Photovoltaic Module

The GeoFlex Series features a foldable polygonal solar panel design, adaptable to shapes like hexagons or octagons for customizable power output. Its foldable structure reduces packaging volume by over 50%, lowering international shipping costs. With a modular design, it easily expands for higher power needs, while 360-degree charging ensures maximum sunlight capture.

The vertical cylindrical panels provide superior wind resistance and a sleek, urban-friendly design that prevents snow accumulation and enhances durability. Ideal for solar streetlights, surveillance systems, and traffic signals, the GeoFlex Series combines functionality, efficiency, and seamless urban integration.



Hexagon

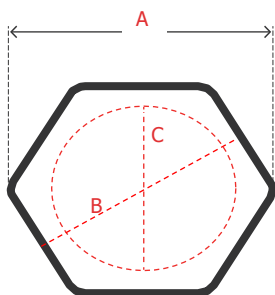

OCTAGON

8 Sides
A = 10.62" B = 11.41" C = 7.48"

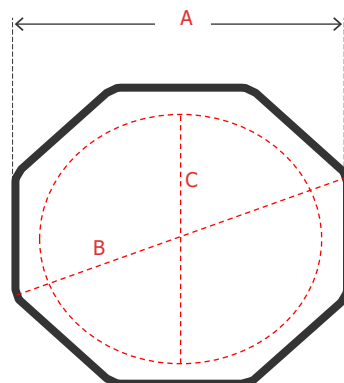

HEXAGON

6 Sides
A = 8.85" B = 7.71" C = 4.72"



Octagon

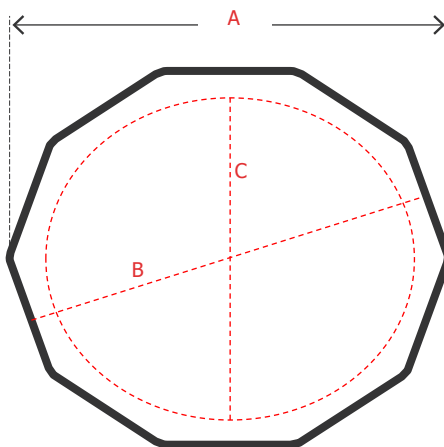

DECAGON

10 Sides
A = 14.17" B = 13.38" C = 10.23"

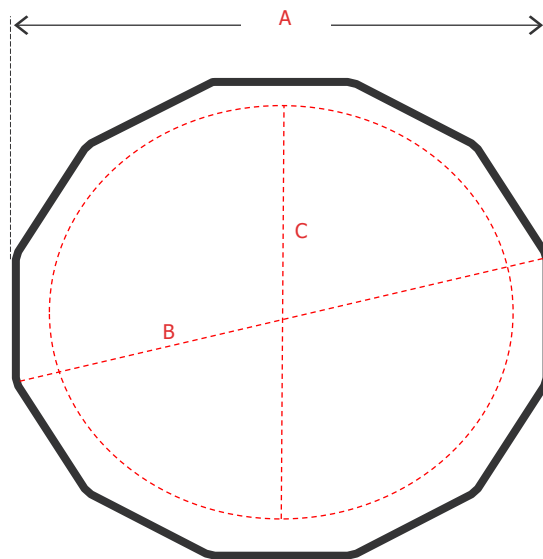

DODECAGON

12 Sides
A = 16.14" B = 16.73" C = 12.99"



Decagon

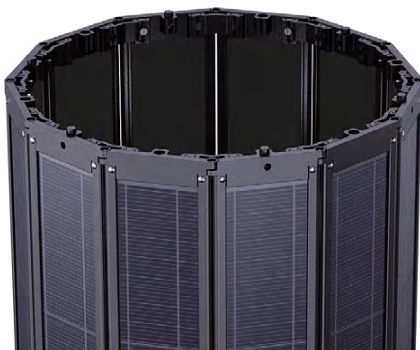

Dodecagon

Vertical Solar Tube

80W I 100W I 140W

Designed in U.S.A and assembled in P.R.C, SolarWrap vertical solar cylinder represents an innovative solution tailored for pole-mounted Applications. Distinguished from conventional solar panels, poles equipped with the SolarWrap cylinder exhibit exceptional aesthetic appeal, seamlessly integrating into serene environments while retaining the appearance of traditional poles, albeit enhanced with beauty. Its versatility extends to various Applications including solar light poles, solar camera poles, and solar traffic signs.



Main Specification

Model	VST-80	VST-100	VST-140
Specification	80W 6V MONO	100W 6V MONO	140W 9V MONO
Dimension	D6.29"*40.94"	D6.29"*40.94"	D9.44"*40.94"
Pole diameter	2.36"~3.54"	2.75"~4.72"	3.14"~6.69"
Cell efficiency	22.5%	●	●
Structure material	Tempered glass + aluminium alloy profile		●
Lifetime	>20 years lifetime	●	●
Warranty	5 years	●	●



Lithium Battery Cylinder

Built into Poles I Outside of Poles

Introducing the S&R Series Lithium Battery Pack – the ultimate power solution tailored for outdoor lighting and versatile Applications. Designed to fit seamlessly within lamp poles, the S & R Series redefines efficiency and durability, making it the perfect choice for solar streetlights, solar-powered surveillance systems, and solar advertising displays.

Crafted with a robust aluminum alloy casing and an IP67 waterproof rating, this battery pack is built to withstand the toughest environmental challenges. Its customizable capacity ensures it adapts to your unique energy needs, delivering unmatched performance.

Whether powering outdoor systems or providing rapid indoor electricity supply, the S & R Series guarantees reliability and flexibility. Elevate your projects with this state-of-the-art energy solution, engineered for excellence in every detail.



Lithium Battery Cylinder

S Series

LiFePO4 Lithium Battery Cylinder



Battery Spec	S1236	S1260	S1290	S2560
Battery Cell	6000mA 3.2V 32700	●	●	●
Nominal Capacity	12.8V 36AH	12.8V 60AH	12.8V 90AH	25.6V 60AH
Battery Cell Quantity	24 pieces	40 pieces	52 pieces	80 pieces
Array Mode	6P4S	10P4S	13P4S	10P8S
Dimension (L*W*H)	12.59''*4.92''*4.25''	20.07''*4.92''*4.25''	27.95''*4.92''*4.25''	36.22''*4.92''*4.25''
Net Weight	9.03lbs	11.68lbs	18.07lbs	27.55lbs
Charge Mode	C.C +C.V	●	●	●
Charge Cut-off Vol	14.6±0.05V	●	●	●
Discharge Cut-off Volt	11±0.05V	●	●	●
Storage Temperature	41F~95F	●	●	●
Operating Temperature	5F~+113F	●	●	●
Lifetime (D.OD. 60%)	4,000 cycles	●	●	●
Warranty	3 Years	●	●	●

R Series

LiFePO4 Lithium Battery Cylinder



Battery Spec	R1260	R1290	R2460	R2490
Battery Cell	15000mA 3.2V 32140	●	●	●
Nominal Capacity	12.8V 60AH	12.8V 90AH	25.6V 60AH	25.6V 90AH
Battery Cell Quantity	16 pieces	24 pieces	32 pieces	40 pieces
Array Mode	4P4S	6P4S	4P8S	5P8S
Dimension (L*Dia)	L13.38''*D5.90''	L24.40''*D5.90''	L24.40''*D5.95''	L47.24''*D5.95''
Net Weight	12.12lbs	17.19lbs	22.70lbs	34.17lbs
Charge Mode	C.C +C.V			
Charge Cut-off Voltage	29.2±0.05V			
Discharge Cut-off Voltage	22±0.05V			
Storage Temperature	5F~95F			
Operating Temperature	5F~+113F			
Lifetime (D.OD. 60%)	4,000 cycles			
Warranty	3 Years			

SOLAR STREET LIGHT

USES AND APPLICATIONS GUIDE

Streets Lighting	V
Parking Lots	V
Residential Roads	V
Public Parks	V
Sports Lighting	V

ORDERING GUIDE

Ordering Guide: EXAMPLE: HIGHLIGHT SP-SODL-A-**RD-18V-**80W-20W-2-30K-36AH-BLK-00

Model	Solar panel Qty.	Solar panel type	Voltage	Solar panel	LED Power	Distribution type	LED Color Temp	Battery options	LED body color	Motion sensor
HIGHLIGHT SP-SODL	A- 1 pc	**RD-Round	18V	**80W	20W	2- Type II	30K	36AH	BLK- Black	00 – No motion sensor
	B- 2 pcs	HE-Hexagon	36V	**100W	30W	3- Type III	40K	60AH	*Other colors	01 – Motion sensor
	C- 3 pcs	OC- Octagon		**140W	40W	4- Type IV	60K	90AH	available	
	D- 4 pcs	DE- Decagon		150W	50W	5 - Type V	*Amber			
		DO- Dodecagon		200W	60W		(-MOQ- 200pcs)			
				250W						
				300W						

***Can customized per to customer requirement**

Legal Clarification: All technical information and/or products listings and/or technical support, and/or any kind of graphics, illustrations and/or instructions and/or the names, trade names, trademarks, trade symbols, service marks, logos, icons and trade dress of SolarPath Inc or in connection to SolarPath Inc or any of its selling products, contained herein is in the exclusive ownership of SolarPath Inc and may not be alternated and/or used in any manner including but not limited to copy of some or all of the said material by users and/or viewers or any third party for that matter of this document and the website to which it is linked without the express prior written permission of SolarPath Inc. Furthermore, redistribution or any kind of commercial use or alternation or any kind of use other than downloading presented information in some or all contents of downloadable documents, and/or downloadable contents, is strictly prohibited without express written prior permission. All information set out herein is subject to changes as may occur from time to time. SolarPath Inc is not responsible for, and cannot guarantee and shall not be held liable for any information or the accuracy of such in websites that it does not manage



Contact us



+1.201.490.4499

Toll free: 1.888.333.SOLAR (7652)



contact@solarpathusa.com



www.solarpathusa.com