

Solar bollards SPBS3

Installation instructions



Caution

1. The lamp is equipped with an internal replaceable battery pack. If you need to replace the battery pack, please contact the seller.
2. Because this lamp is solar powered, please install it in a location where can get enough sunshine.
3. Lighting time depends on sunshine duration and weather.
4. Intelligent IC comes with built-in over-charge, over-discharge and over-voltage protection.
5. The lamp will automatically light at dusk and turn off at dawn.
6. Lamp should only be serviced by professionals.
7. Do not dispose of the battery with household garbage to avoid explosion.

Product



Product dimensions

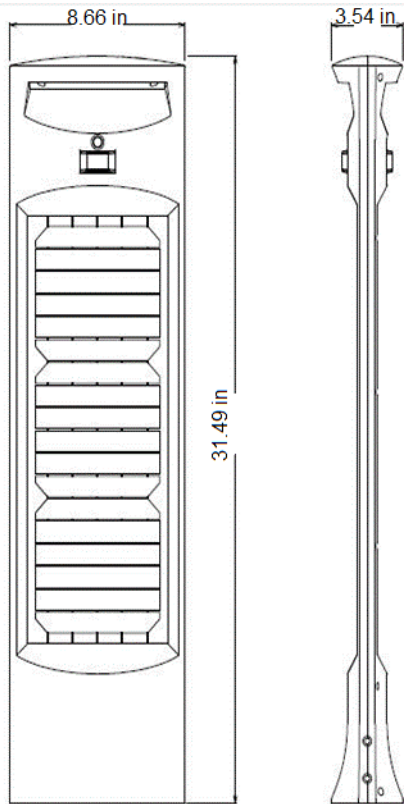

Working mode

Remarks:

There is one button on each side of the lamp. Press the button to select the working mode for each side individually. The lamp can be charged in any mode. First press of the button is Sensor Mode. Second press of the button is Constant Lighting Mode. Third press of the button is off.

Sensor Mode:

Automatically turns on to full brightness (2000lm) when motion is detected in the range ≤ 26.24 ft and then turns to weak brightness (300lm) in 20 seconds of no motion.



Constant Lighting Mode:

Automatically turns on at dusk and remains at 50% brightness (1000lm) until dawn or powers off.

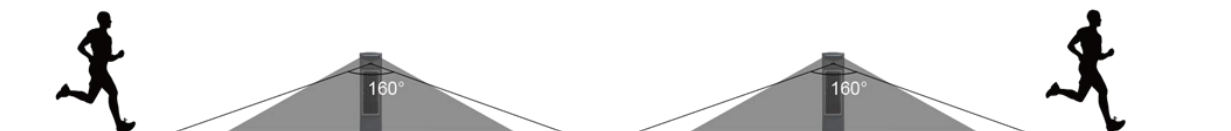

Installation

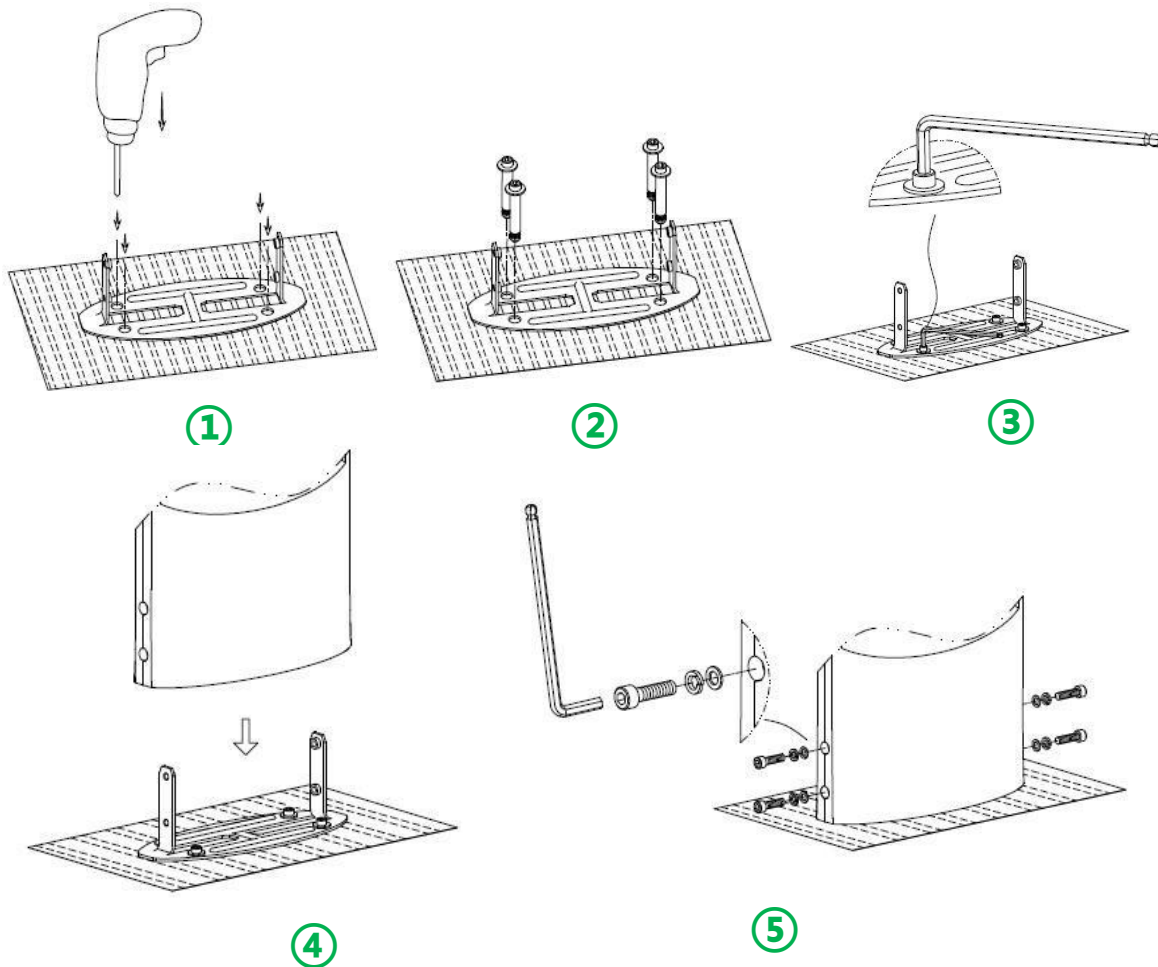

1. Verify that lamp, accessories and tools are present.
2. Drill four holes of 0.39-inch width and 2.75-inch depth on the flat concrete ground. (picture ①)
3. Insert the expansion screws into the holes and lock the expansion screws with Allen Wrench. (pictures ②-③)
4. Put the lamp onto the metal bracket and align the four holes, then lock the lamp and metal bracket with screws, spring washers and gaskets. (pictures ④-⑤)

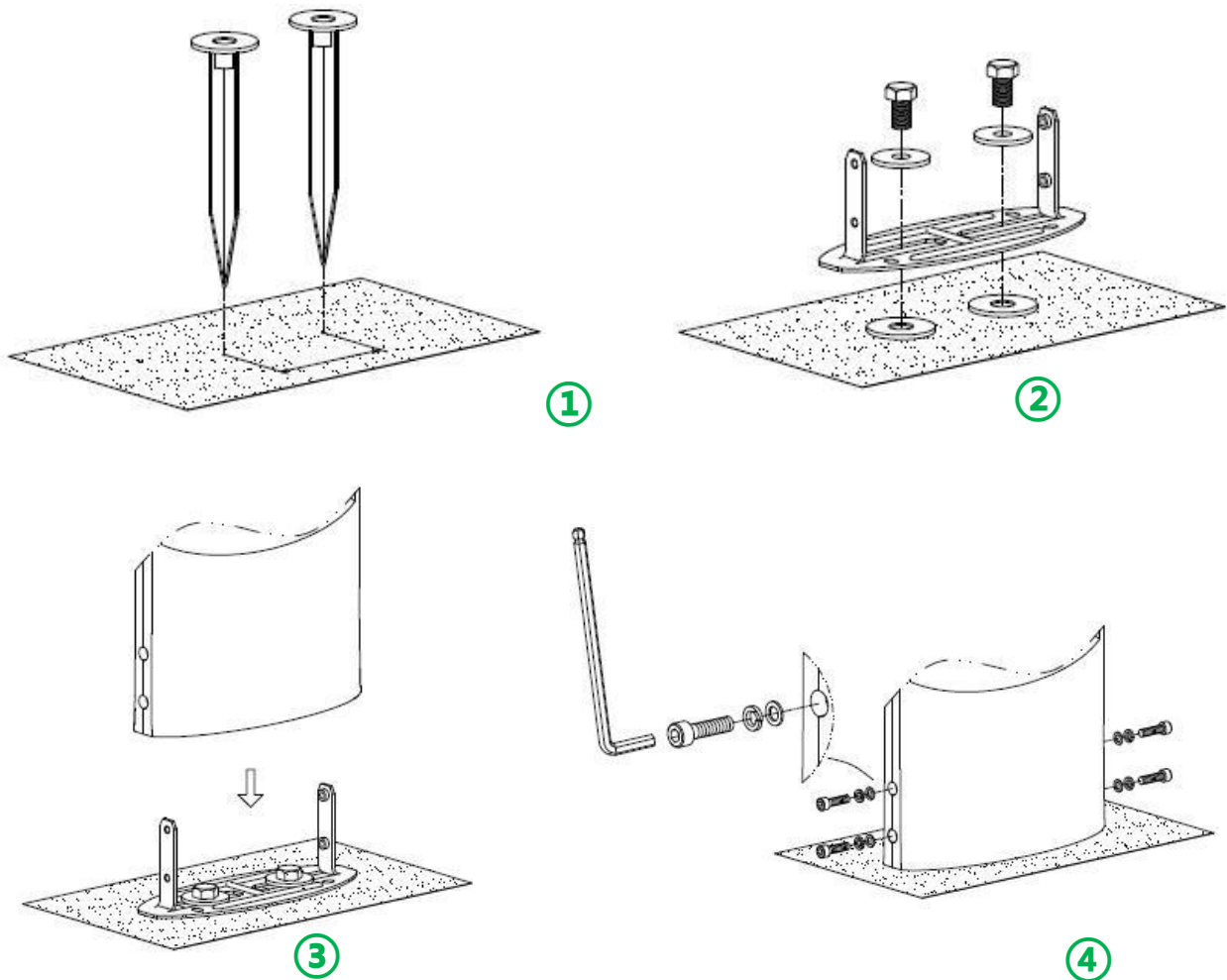

1. Verify that lamp, accessories and tools are present.
2. Insert two spikes into the lawn with a space of 2.36 - 4.72 inches between them. (Picture ①)
3. Use screws and gaskets to fix the metal bracket onto the surface of spikes. (Picture ②)
4. Put the lamp onto the metal bracket and align the four holes, then lock the lamp and metal bracket with screws, spring washers and gaskets. (Picture ③-④)

Battery replacement

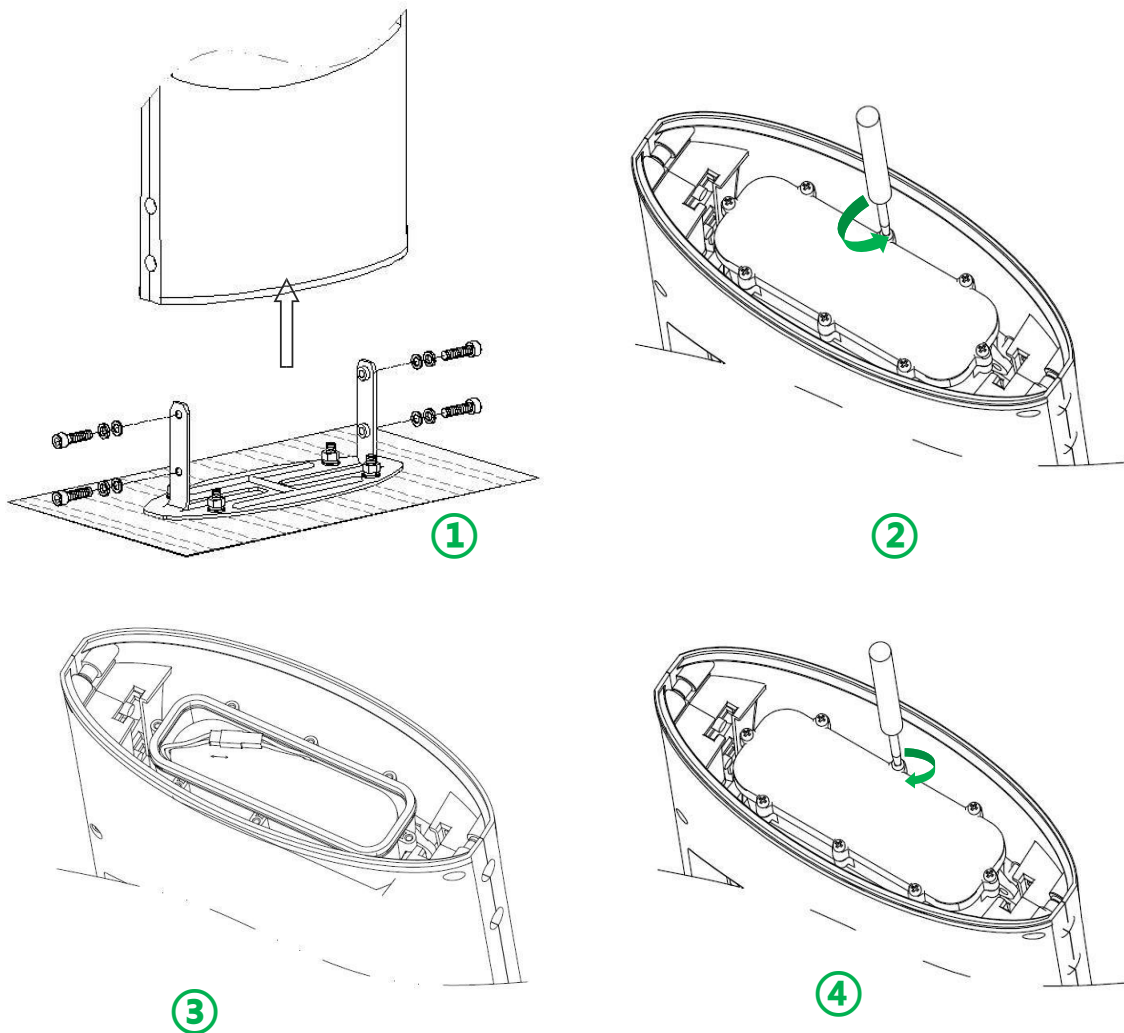

1. Loosen the four screws on the side of the lamp and lift up the lamp. (see picture ①).
2. Loosen the battery cover screw, open the battery cover, and replace the corresponding battery pack. (see picture ② ③)
3. After replacing the battery, lock the battery cover and install the lamp onto the metal bracket. (see picture④)