



Circle Light

Circle Light



- Remote control-Simple operation, change to different modes easily.

Advantage:

- Wireless application-Integrated solar panel, LED, lithium battery, micro-controller and other accessories into one system, simple and stylish.
- Micro-computer controlled-Combine motion sensor system, light control system and time control system perfectly, ensure whole system more energy-efficient.
- Easy installation-No power required, no cables required, easy installation in 2 minutes.
- Solar panel angle adjustable-Adjustable in vertical and horizontal direction, ensure maximum efficiency of solar energy conversion.
- Extreme light-Light efficiency reach 160lm/w, at same illumination, lower watt available.
- Lithium battery-Adopt lithium battery to replace traditional gel battery, longer lifetime.
- Modular design-All components are modular design and in standardized production.
- Long time working-Working continuously for 2-3 rainy days.
- Low cost-Compared with traditional solar led lights, much lower cost, easy to transport.

Feature:

- Beautiful and modern appearance, simple and fashionable.
- Use of solar green energy, environment friendly, saving more.
- Low voltage driving, meet the Europe standard of CE RoHS FCC.
- No Hg, Pb or other hazardous materials, no radiation, human safety.
- IP65 grade, TVS lightning protection.
- Long lifetime of whole lamp, low maintenance costs.

Details:

Monocrystalline



- 18% photoelectric Conversion efficiency
- Tempered glass cover
- 20-25 years lifetime

High lumen led chip



- 45 mil led chip, 160lm/w
- ≥50000hrs lifetime
- ≥70Ra CRI

SolarPath Smart Controller



- **SolarPath Unique Design**
- 6 control modes, light control, motion sensor control Time control, motion sensor and time control, demo mode, off mode
- Smart Control, saving more and system works stably

LiFePO4 battery



- High Capacity
- No pollution and stable
- 5-8 years lifetime, ≥2000 times charge & discharge
- High Temperature resistance

High Quality Body







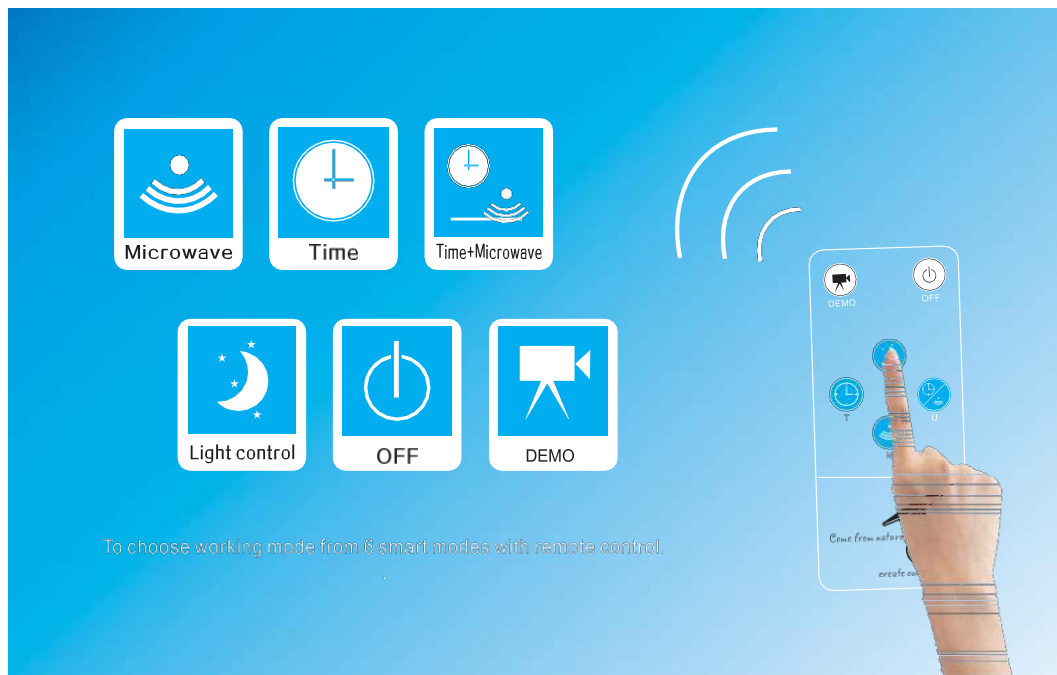

- Aluminum alloy, solid, and firm
- Zinc Plated, anti-rust corrosion

Remote Control



■ Six working mode choices

-  **DEMO:** No matter day or night, light "on" when people close, light "off" after people left. Only for test use.
-  **OFF:** Light "off", no matter day or night.
-  **L:** At night, 100% light for 2hours, 80% for another 2hours, then light 50% till the dawn. Lighting for 1.5days.
-  **T:** At night, 100% light for 2hours, 60% light for another 2hours, then light "off". Lighting for 3days.
-  **U:** At night, 100% light for 2hours, 60% light for another 2hours, then turn to motion sensor, 60% light when people close, 20% light after people left. Lighting for 2days.
-  **M:** At night, 100% light when people close, 30% light after people left. Lighting for 2.5days.

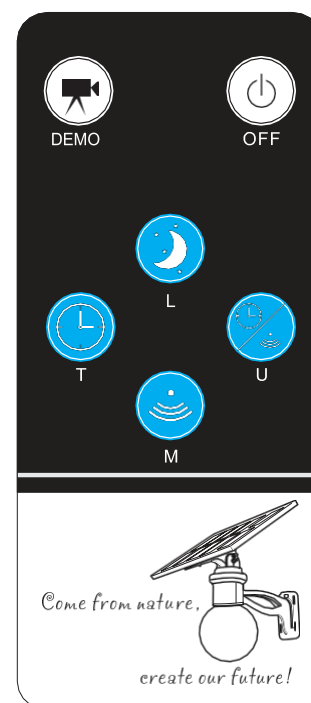

Remark: Default is U mode, you can choose the best mode according the light condition in your city.

■ Attentions of motion sensor function

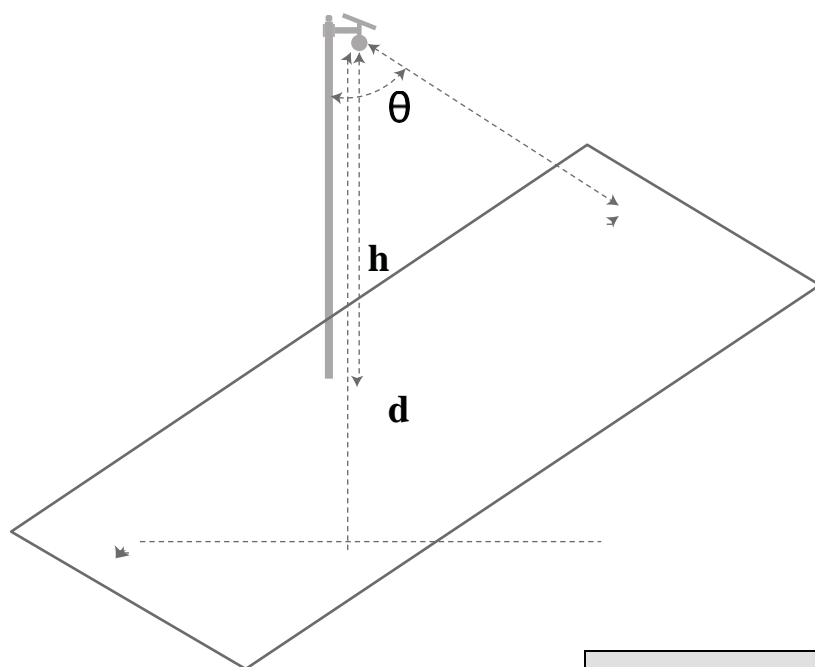

θ (Angle)	h (Height)	d (width)
65°	19.6FT	32.8FT

1. Sensor should be installed under 19.6 FT Height

Applications:

Widely used in Park, Villa, Village, Square, Courtyard, Farm, School, Desert, Prairie, Path etc. The places where outdoor sunlight is needed the most.



Easy installation in 2 minutes!

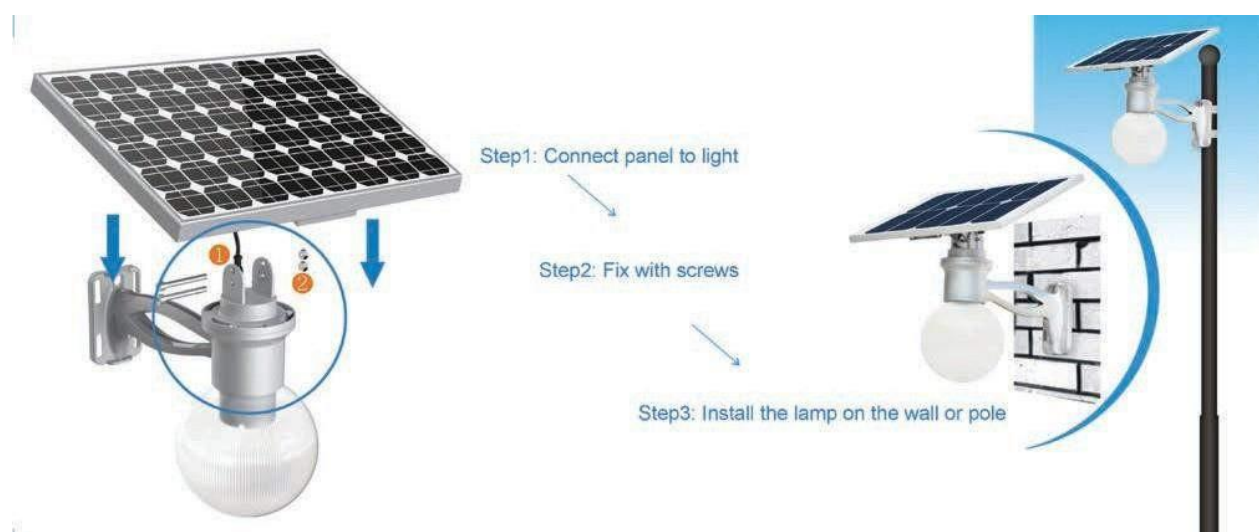

Solar panel angle adjustable schematic diagram:



Parameters:

Type	SP-CL12	SP-CL25	SP-CL40
LED Power	4W	8W	12W
Solar panel	12W/5	25W/5V	40W/13.5V
Lithium battery	10AH/3.2V	20AH/3.2V	10AH/9.6V
LED qty	6pcs	6pcs	12PCS
Box Size	18.1*13.3*11.8in	19.29*15.1*11.8in	25.9*18.7*10.6in
Luminous flux	600-720lm	1200-1440lm	1500-1800lm
LED chip	Bridgelux		
Color temperature	3000-6500K		
CRI	≥70Ra		
Light control voltage	1V		
Illumination (stand by)	30%		
Sensor area	<32.8 FT		
Delay time	20s		
Charge time (full sunlight)	4hrs		
Working temperature	-4F- 140F		
Lifetime	≥50000hours		
Material	High quality aluminum alloy, die-cast aluminum		
Mounting height (recommended)	9.8--19.6FT		
Installation spacing (recommended)	26.2-32.8 FT		

The working time will be affected by the surroundings.

Moon light dimension

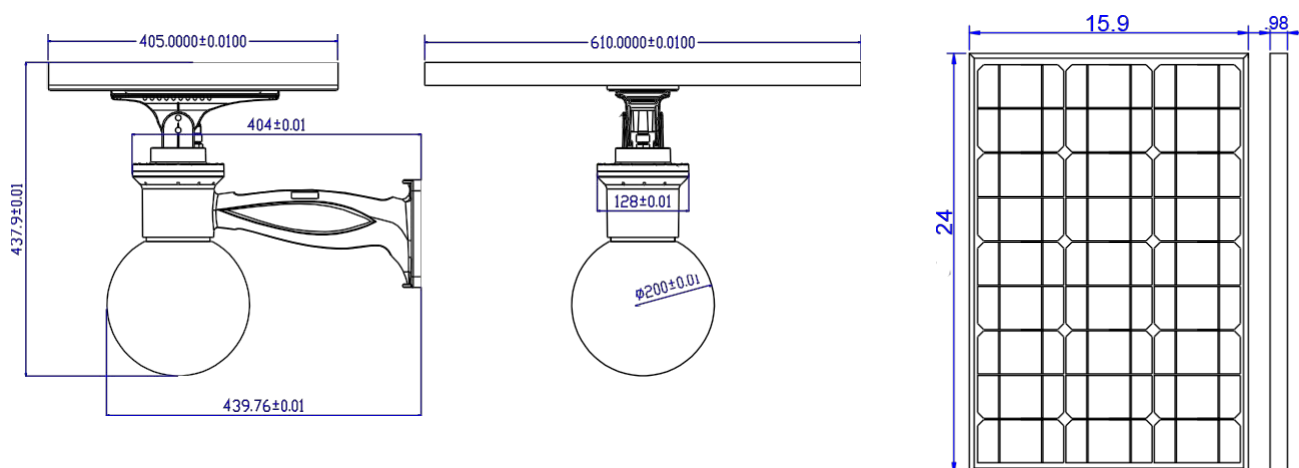
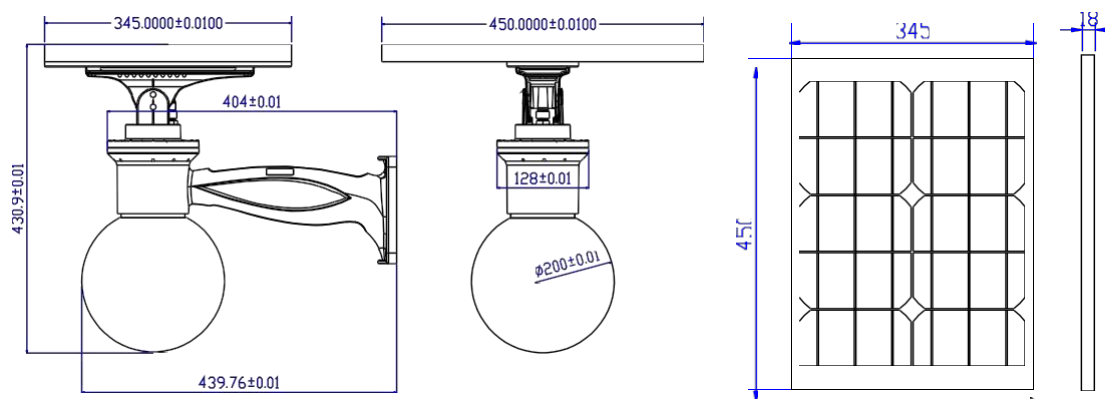
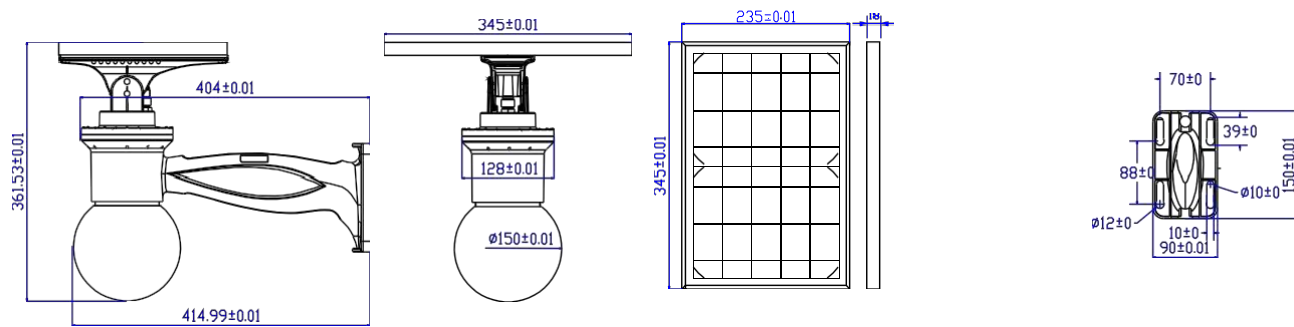

Instructions:

- Solar Moon light, need solar power to charge battery, please select appropriate model based on local sunshine conditions.
- Please avoid solar panel be block by building, trees or other obstructions, otherwise it will reduce efficiency of solar panels working, resulting in lower efficiency of system.
- Charging temperature of Lithium battery is 32F to 131F the discharging temperature is -4F to 140F make sure that ambient temperature is in this range when used, avoid damage to lithium battery.
- Please cleaning surface of solar panels regular, such as dirt, leaves, oil, etc., ensure high photoelectric conversion efficiency.
- Cleaning snow of solar panel surface timely in winter.

Package specification:

List of accessories

- 304 expansion screws & spacer & nut..... 4 sets
- Fixed the back light pole.....1 pc
- 304 hexagonal screw M6 & nut..... 2 sets
- 304 hexagonal screw m6....., 3pcs
- Hexagon wrench M5.....1pc
- Open spanner M10.....1pc
- Remote control.....1pc

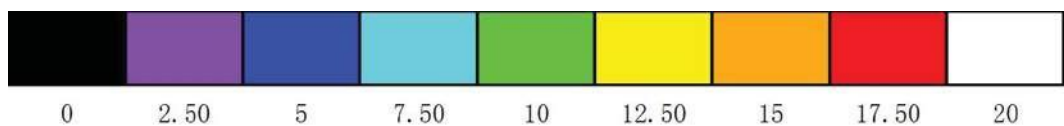
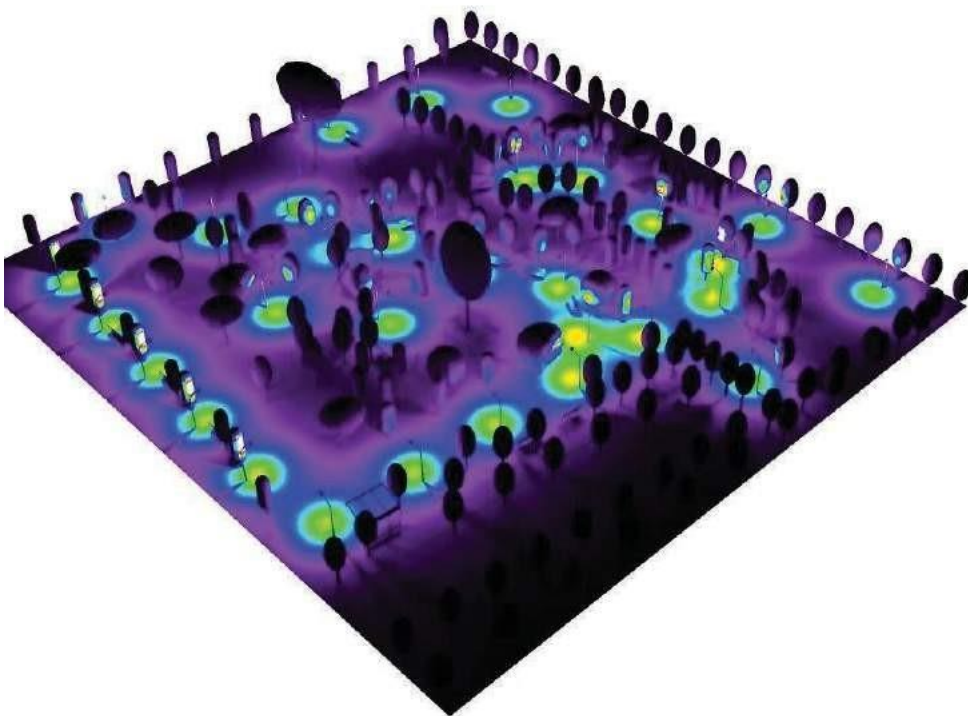
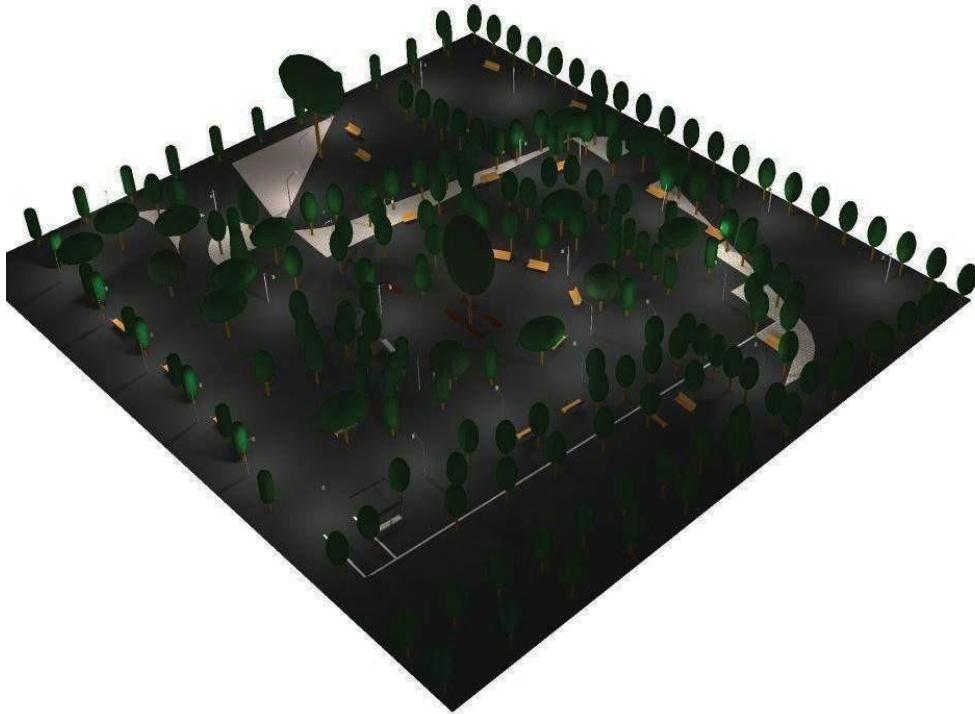

lx